

## • Features

1. Chip material: InGaN
2. Emitted color: Blue
3. Lens appearance: Water Clear
4. Low power consumption
5. High efficiency
6. High reliability and long life
7. PLCC package
8. RoHS compliant

## • Applications

1. Panel Indicator
2. Monitor
3. Audio Indicator
4. Computer
5. Circuit board

## • Package Dimensions

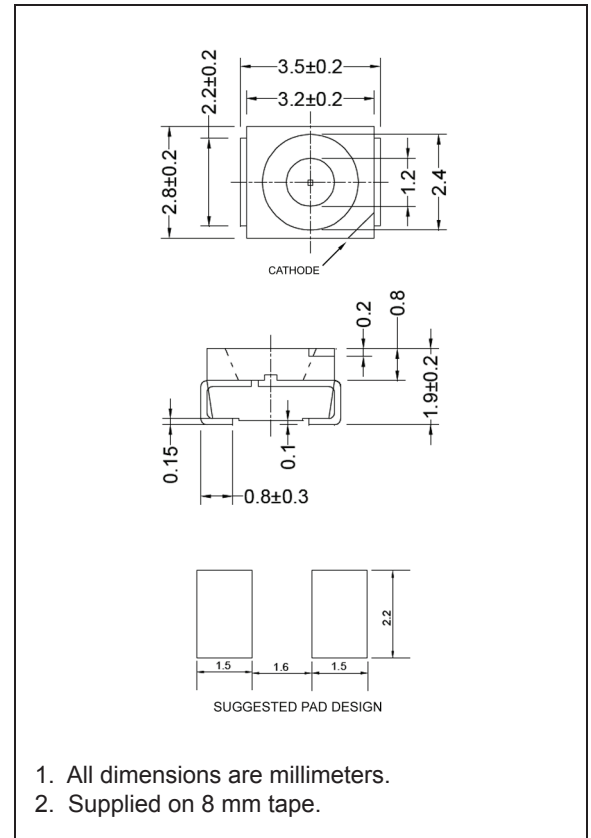

## • Absolute Maximum Ratings ( $T_a = 25^\circ \text{C}$ )

| Parameter                               | Symbol    | Rating   | Unit             |
|---|-----------|----------|------------------|
| Power Dissipation                       | $P_D$     | 90       | mW               |
| Forward Current                         | $I_F$     | 25       | mA               |
| Peak Forward Current *                  | $I_P$     | 100      | mA               |
| Reverse Voltage ( $I_r=30\mu\text{A}$ ) | $V_R$     | 5        | V                |
| Operating Temperature                   | $T_{OPR}$ | -40 ~ 85 | $^\circ\text{C}$ |
| Storage Temperature                     | $T_{STG}$ | -40 ~ 85 | $^\circ\text{C}$ |
| Soldering Temperature                   | $T_{SOL}$ | 260**    | $^\circ\text{C}$ |

\* Condition for  $I_{FP}$  is pulse of 1/10 duty and 0.1 msec width.

\*\* for 5 seconds

• **Electrical and Optical Characteristics** ( $T_a = 25^\circ \text{C}$ )

| Parameter                          | Symbol          | Condition         | Min. | Typ. | Max. | Unit          |
|------------------------------------|-----------------|-------------------|------|------|------|---------------|
| Forward Voltage                    | $V_F$           | $I_F=20\text{mA}$ | -    | 3.0  | 3.6  | V             |
| Reverse Current                    | $I_R$           | $V_R=5\text{V}$   | -    | -    | 30   | $\mu\text{A}$ |
| Luminous Intensity                 | $I_V$           | $I_F=20\text{mA}$ | -    | 200  | -    | mcd           |
| Peak Wavelength                    | $\lambda_P$     | $I_F=20\text{mA}$ | -    | 465  | -    | nm            |
| Dominant Wavelength                | $\lambda_D$     | $I_F=20\text{mA}$ | -    | 468  | -    | nm            |
| Spectral Bandwidth (50% of $I_V$ ) | $\Delta\lambda$ | $I_F=20\text{mA}$ | -    | 30   | -    | nm            |
| Viewing Angle                      | $2\theta_{1/2}$ | $I_F=20\text{mA}$ | -    | 120  | -    | deg           |

• **Typical Electro-optical Characteristic Curves**

